

Rev. No.	Revision Note	Date	By	Checked
A12	REVISED REACTOR DESIGN	14-MAY-2020	CG	AH
A13	REVISED BRACKET DESIGN	28-APR-2021	CG	BDK

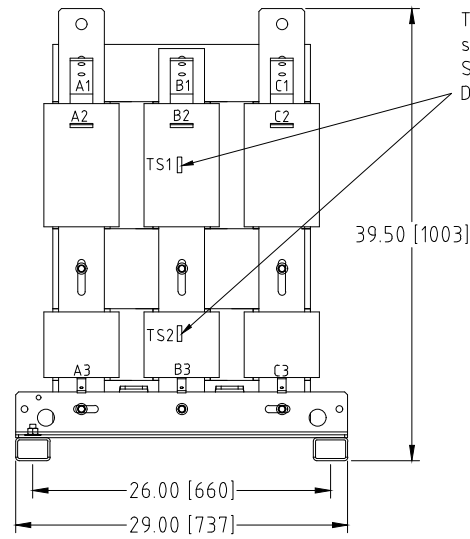

Front View

Temperature switches. See Connection Diagram

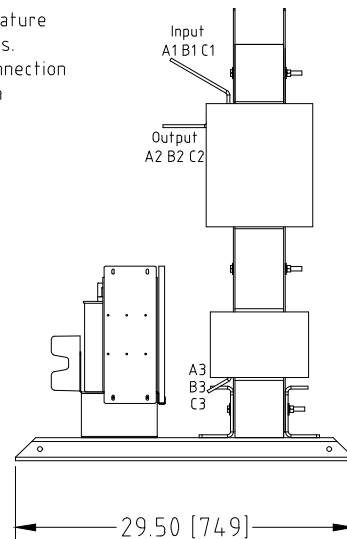

Side View

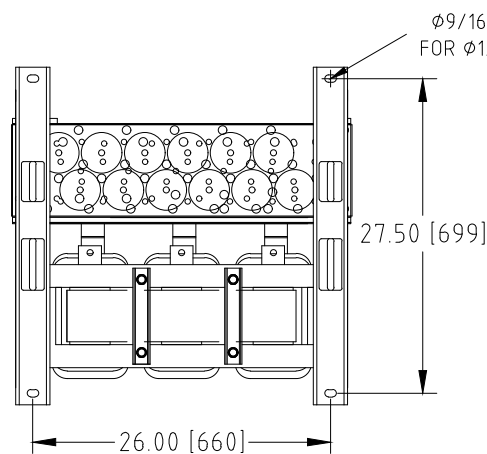

Bottom View

Ø9/16" HOLE FOR Ø1/2" ANCHOR

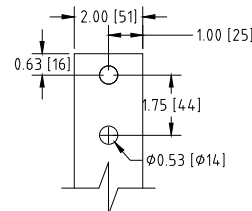

Input A1,B1,C1 & Output A2,B2,C2 TERMINALS THICKNESS: 1/4"

Connection Diagram

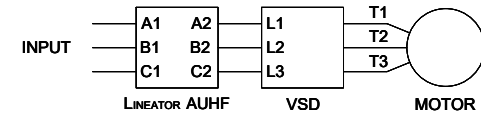

UNIT SPECIFICATIONS

HP [kW]	PHASE	VOLTS	Hz	INPUT	OUTPUT	APPROX. WT
				AMPS	kW	lb [kg]
500 [400]	3	600	60	475	443	563 [256]

NOTES:

- CUSTOMER IS RESPONSIBLE FOR INSTALLATION TO MEET ALL NATIONAL AND LOCAL ELECTRICAL CODES AND OTHER APPLICABLE ELECTRICAL SAFETY AUTHORITIES.
- CUSTOMER IS RESPONSIBLE FOR PROPER COOLING OF FILTER COMPONENTS. ALLOWED AMBIENT: MAXIMUM 60°C, MINIMUM -40°C. A MINIMUM CLEARANCE OF 2" MUST BE ALLOWED ON BOTH RIGHT AND LEFT SIDES. PROPER VENTILATION MUST ENSURE THAT SUPPLY AIR FLOWS THROUGH THE REACTOR COILS FROM BELOW THE UNIT.

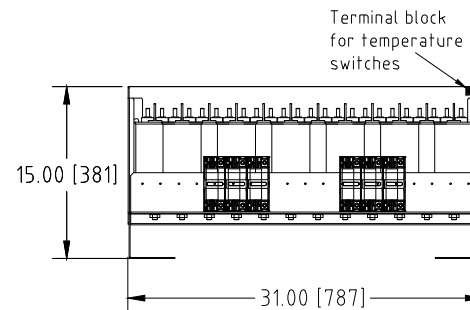

Capacitor Board

TEMPERATURE SWITCH Connection Diagram

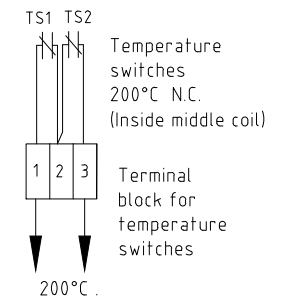

Customer's Circuit

MIRUS International Inc.

31 Sun Pac Boulevard, Brampton, ON, Canada L6S 5P6
Tel: (905) 494-1120 Fax: (905) 494-1140 Toll Free: 1-888-T0 MIRUS

Unless otherwise specified, dimensions are in inches and [mm].	Drawn By CW	Date Created 10-Jan-07	Checked by YM	Approved by - date YM-10-Jan-07	Scale NTS
The information contained herein is the sole property of MIRUS International Inc. Any form of reproduction, distribution and/or disclosure of this information, all or in part, is strictly prohibited without the express written consent of MIRUS International Inc.		Title 500 HP, 600 V, 60 Hz LINEATOR™ AUHF (Open Style)		Revision A13	Sheet 1/1
Filename AUHF-500-600-60-D-E0-A13					